

AIR PURIFIER

MODEL

MA-E85R-A

INSTRUCTION MANUAL



Table of Contents

	Page	
● Features	2	Before Use
● Tips on Use	2	
● Points to Note	3	
● Safety Precautions	4	
● Attentions	5	
● Names and Functions of Parts	6	
● Main Unit ● Control Panel		
● Preparation	8	
<hr/>		
● Operation	9	Operation
● Operating the Louvre	10	
● Automatic Cleaning (Pre-filter)	11	
<hr/>		
● Cleaning		Maintenance
● When Dirty	12	
● When the Clean Dust Box Lamp Lights Up or Approximately Once Every Four Months...	14	
● Approximately Once a Month	14	
● Approximately Once Every Six Months.....	14	
● When There is an Odor Coming Out of the Air Outlet.....	15	
● Replacement of Filters and Disposal ...	16	
<hr/>		
● Troubleshooting	17	Troubleshooting
● Specifications	Back cover	

- Before use, please read this instruction manual carefully to ensure proper and safe use.
- Make sure you receive the warranty card from your dealer and ensure that it contains all the information such as your purchase date and the name of the dealer, etc.
- Please keep the instruction manual and warranty card.

Features

Quickly eliminates contamination in the air before it spreads into your room using a PM2.5 Sensor and Smart Search.

● Smart Search

The louvre moves in 5 stages and automatically searches for contamination in the air.

● Cleaning Mechanism

The pre-filter automatic cleaning function reduces deterioration in performance due to clogging with dust. The dust on the pre-filter is collected into the dust box.

● Platinum Catalyst and Special Washable Activated Charcoal

Excellent deodorizing is provided by the platinum catalyst and special washable activated charcoal. Soaking and washing the activated charcoal reduces deterioration of the deodorizing performance.

● Reduction of Airborne Viruses*

* This is the effect on airborne viruses achieved after operation for 11 minutes in a test space of a 25 m³, and is not the result of verification in a space that is in actual use. Manual operation (Turbo) (510 m³/h) <Testing body> Virus Research Center, Sendai Medical Center, National Hospital Organization <Test method> The performance evaluation test of the voluntary standard (JEM1467) issued by The Japan Electrical Manufacturers' Association was performed in a 25-m³ test space. <Test object> 1 type of airborne virus <Test result> 99% reduction in 11 minutes

● PM2.5 Sensor

Improved small particle detection speed and accuracy. It can even detect 0.5- μ m particles.

● Large Air Volume

The maximum air volume of 510 m³/h facilitates quick suction of a large amount of pollen and dust.

● Support for PM2.5

Catches 99%* of particles from 0.1 to 2.5 μ m.

Consideration is not given to new particles entering from outdoors due to, for example, ventilation.

- PM2.5 is a generic term for fine particulate matter of 2.5 μ m or less.
- The removal of fine particulate matter less than 0.1 μ m with this air purifier has not been verified. Also, this air purifier is not capable of removing all harmful substances from the air.
- This is the effect achieved in a 30-m³ enclosed space, and is not the result of verification in a space that is in actual use.

* <Testing laboratory> SHANGHAI ENTRY-EXIT INSPECTION AND QUARANTINE BUREAU MECHANICAL & ELECTRICAL PRODUCTS TESTING CENTER

<Test method> Performed by regulating the initial concentration of particulate matter within the range of (5.0 \pm 1.0) mg/m³ in a 30-m³ test space

<Test results> 99% eliminated in 20 minutes

● Two-layer HEPA Filter

Comes equipped with a HEPA filter that catches 99.97% of 0.3- μ m pollen and house dust.

Frequently Asked Questions

What will happen if cleaning is not performed?

If a lot of dust adheres to the HEPA filter, performance may deteriorate remarkably.

Will all cigarette smoke be removed?

The air purifier can remove nicotine and other particles, but the room needs to be ventilated occasionally because carbon monoxide (CO), a harmful substance contained in cigarette smoke, cannot be removed. Furthermore, when a lot of cigarettes are smoked, cigarette odor may be emitted from the unit.

Tips on Use

Recommended operations for various situations

Operation P.9

For quick and powerful automatic removal of contamination and odor from the air

<Manual>
Turbo

Operation is performed continuously with maximum air volume.
When smoking cigarettes, cleaning, and making beds

For automatic removal of contamination and odor from the air

<Auto>
Normal/Turbo

The air volume is changed automatically depending on the amount of contamination and odor.

For quiet operation

<Auto>
Night

Operation is performed automatically with low air volume.

When sleeping or a baby is in the room

<Manual>
Silent

Operation is performed continuously with low air volume.

For continuous operation

<Manual>
Silent/Low/Middle/
High/Turbo

Operation is performed continuously with a constant air volume.

Points to Note

● Before Installation

The positions of the air inlets, outlet, PM2.5 Sensor, and odor sensor are as shown in the diagram on the right. Observe the following points.

Do not block the air inlets and outlet by placing an object near it.
→ The air purification function will deteriorate.

Do not block the odor sensor.
→ Odor will become unable to be detected.

Do not block the PM2.5 Sensor.
→ Contamination will become unable to be detected.

This air purifier cannot be used mounted to a wall.

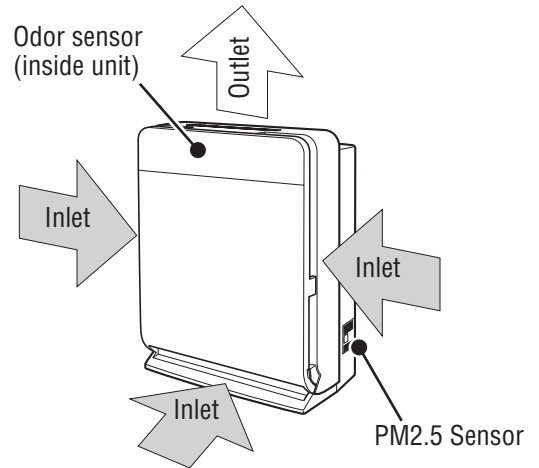

● Installation Procedure

● Install the unit in a location with good air circulation.

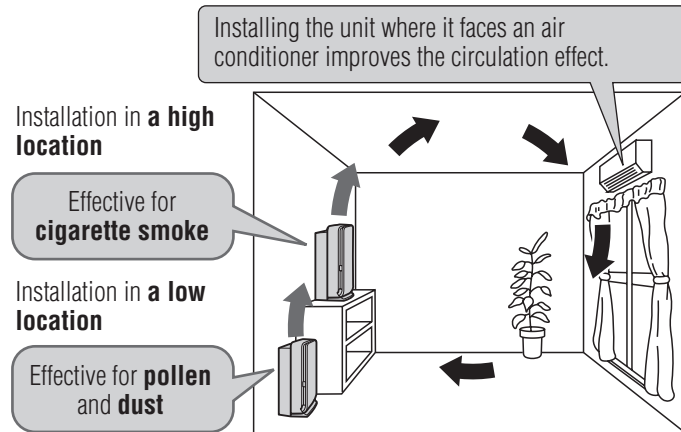

● Leave space around the unit.

If the unit is placed on a surface that is not flat or stable (on carpet, tatami, etc.), it may vibrate.

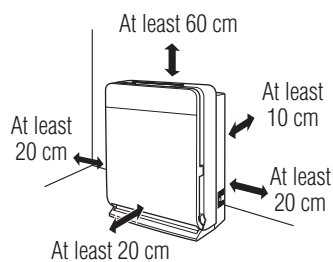

● Observe the following when installing the unit.

Do not place the unit near or on anything that is hot such as a heater.

This may cause malfunction, deformation, or discoloration.

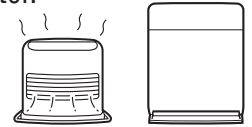

Do not place the unit where it will be subject to direct sunlight.

This may cause deformation or discoloration.

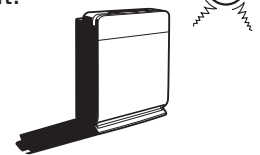

Ensure that there is a distance of at least 1 m from a TV, cordless telephone, air conditioner, personal computer, fluorescent light fitting, etc.

Failure to do so may result in electromagnetic waves interfering with the other equipment.

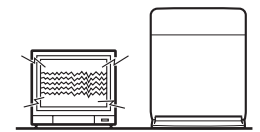

● When Moving the Unit

Turn OFF the operation and unplug the power plug.

While carrying the unit, hold it firmly by the handle and keep the power cord away from the floor not to step on.

If the unit is moved or tilted while it is operating, sound may be emitted from the blower fan.

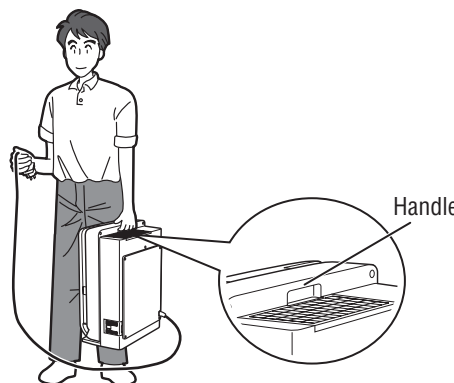

Safety Precautions

■ To prevent personal injury, injury to others, or property damage, the following precautions must be observed.

■ The following categories describe hazards caused by mishandling and their levels.

■ The meanings of the graphic symbols used in this manual and on the unit are as follows.



WARNING

Indicates a hazard caused by mishandling that may result in death or serious injury.



CAUTION

Indicates a hazard caused by mishandling that may result in a minor injury or damage to the home and its contents.



Prohibited



Beware of rotating device



Do not disassemble



Do not use near water



Observe instructions

WARNING



Do not use a damaged power cord and plug, or a loose power outlet.

This may cause **electric shock, short circuit, or fire.**



Do not damage the power cord and plug.

Do not unnecessarily bend, pull, twist, or bind the power cord, place it close to a hot object, place a heavy object on it, trap it between objects, or modify it.

- If the power cord is damaged, it must be replaced by the manufacturer, its service agents, or a similarly qualified person to avoid hazards.

This may cause damage, resulting in **fire or electric shock.**

(Also take care that a pet does not bite the power cord.)



Do not repair, disassemble, or modify the unit.

This may cause fire or electric shock. For repairs, contact the retail store where you purchased the product.

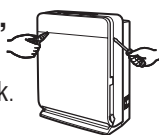

Do not put a wire, pole, or other foreign object or a finger into an air inlet or outlet or any other opening into the unit.

This may cause **electric shock or injury.**



Use a 230-240 V AC power outlet.

Using other than a 230-240 V AC power outlet may cause **electric shock, short circuit, or fire.**



Remove the power plug before cleaning. Also, do not remove the power plug with a wet hand.

This may cause **electric shock or injury.**



Remove dust from the power plug regularly.

If dust accumulates, humidity, etc. may cause an insulation failure, resulting in **fire.**



If the unit is operating abnormally or fails, stop using it immediately.

- The unit does not operate when the operation On/Off switch is turned ON.
- The unit, power cord, or plug is abnormally hot.
- There is an abnormal noise or vibration during operation.
- There is a burning smell.
- The operating sound is abnormally loud.
- Mounting screws are corroded or loose.
- The earth leakage circuit breaker trips frequently.
- There is another abnormality or failure.

Failure to do so may cause fire, electric shock, or injury.

Immediately turn OFF the operation On/Off switch and disconnect the power plug, and then contact the retail store.

This appliance can be used by children aged from 8 years and above and persons with reduced physical, sensory or mental capabilities or lack of experience and knowledge if they have been given supervision or instruction concerning use of the appliance in a safe way and understand the hazards involved. Children shall not play with the appliance. Cleaning and user maintenance shall not be made by children without supervision.

⚠ CAUTION



Do not allow flammable gas to be sucked inside or use the unit where flammable gas accumulates.
(Factory, beauty salon, etc.)

This may cause **fire**.



Do not place the unit close to flammable objects or objects lit with fire, such as cigarettes or incense sticks.

This may cause **fire**.



Do not get on top of or lean against the unit.

This may cause the unit to topple or fall and cause **injury**.



Do not lay the unit horizontally when removing a filter.

This may cause dust to enter inside, resulting in **fire or electric shock**.



Do not use a damaged filter or operate the unit while a filter is removed.

This may cause dust to enter inside, resulting in **fire or electric shock**.



Do not install the unit where water may be spilt onto it or where there is a lot of humidity such as in a bathroom.

This may cause **electric shock**.
Should water or other liquid be spilt onto the unit, stop operation and remove the power plug, and then contact the retail store where you purchased the product.



Do not use the unit in a location with the oily smoke of machine oil or other oil.

This may cause cracking, resulting in **electric shock**.



Do not wipe the unit with benzene or thinner or spray insecticide or other chemicals onto it.

This may cause **electric shock, fire, or cracking and cause injury**.



Do not operate the unit when using an insecticide that produces smoke.

An accumulation of chemical components may be released from the air outlet and be **harmful to your health**.

After using an insecticide, ventilate the area sufficiently prior to operating the unit.



When using the unit in combination with a combustion appliance, ventilate the room occasionally.

Carbon monoxide cannot be removed from the air, so not ventilating the room may cause **carbon monoxide poisoning**.



When disconnecting the power plug, pull it out straight while holding not the cord but the power plug.

Failure to do so may cause **electric shock or a short circuit resulting in fire**.



When the unit will not be used for a long time, disconnect the power plug.

Failure to do so may cause the insulation to deteriorate, resulting in **fire from a short circuit or an electric shock**.

Attentions

This air purifier is designed for household use.
Do not use it for industrial use.

Do not block the air inlets or outlet.

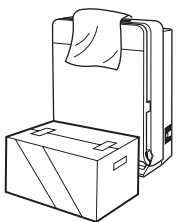

This may cause a **malfunction**.

Do not use this unit instead of an exhaust fan or exhaust hood (there is no ventilation function).

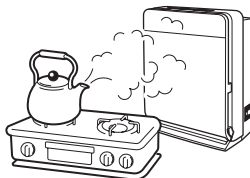

This may cause the filter life to become shorter and cause **deformation, discoloration, or malfunction**.

Do not insert a finger or foreign object into the PM2.5 Sensor.

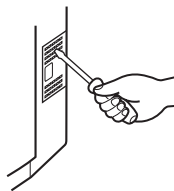

This may cause a **malfunction**.

Do not use the unit while it is laid horizontally.

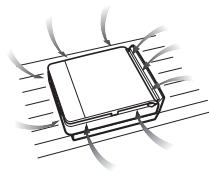

This may cause a **malfunction**.

Do not use the unit while the inlet panel, pre-filter unit, HEPA filter, activated charcoal filter, or platinum catalyst is removed.

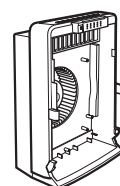

This may cause a **malfunction**.

Names and Functions of Parts

Main Unit

Front

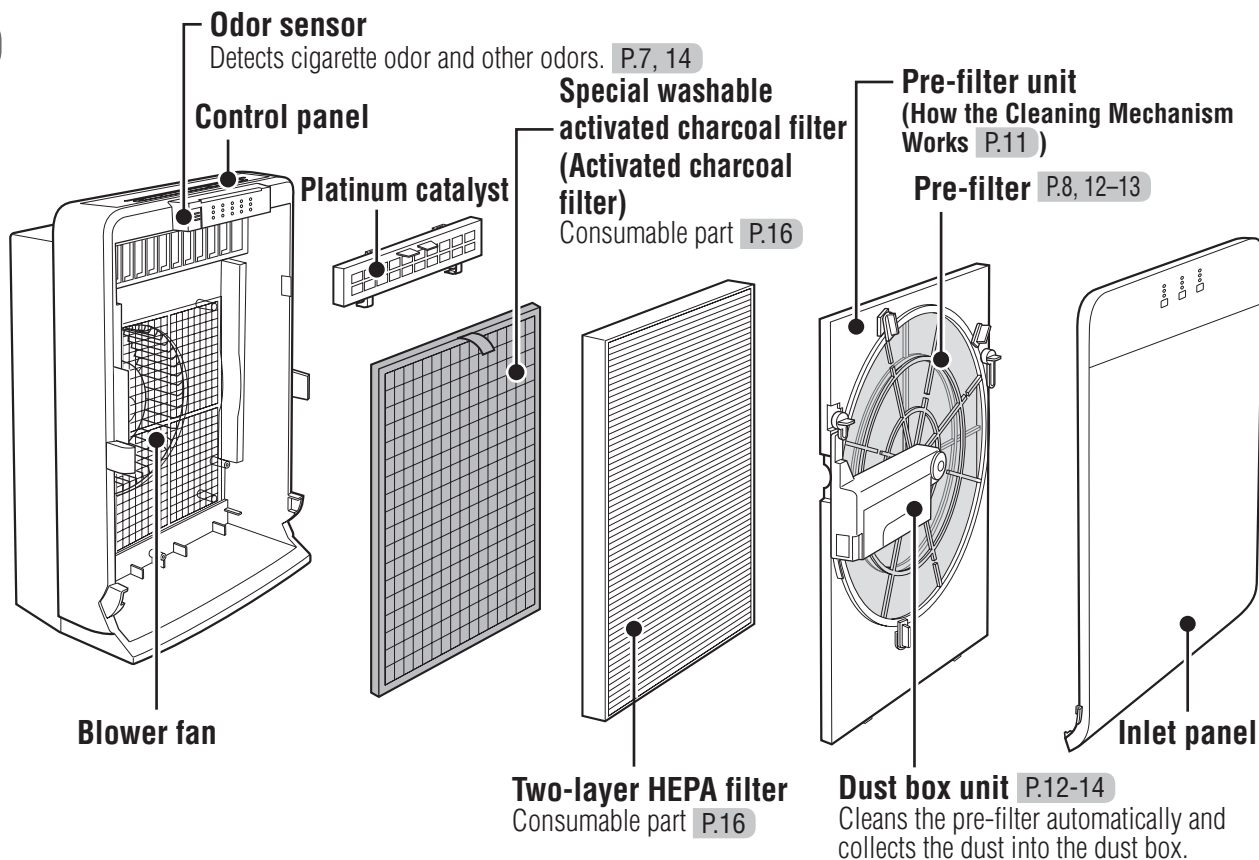

What is a platinum catalyst?

A catalyst that combines platinum, which exhibits high chemical reactivity, with a catalytic substance that has numerous nano-sized pores. It absorbs and breaks down the sources of various odorants causing complex odors in daily life that are difficult to sense.

What is a HEPA filter?

<High Efficiency Particulate Air filter>
A highly efficient filter capable of filtering at least 99.97% of particles with a diameter of 0.3 μm (micrometer).

Rear

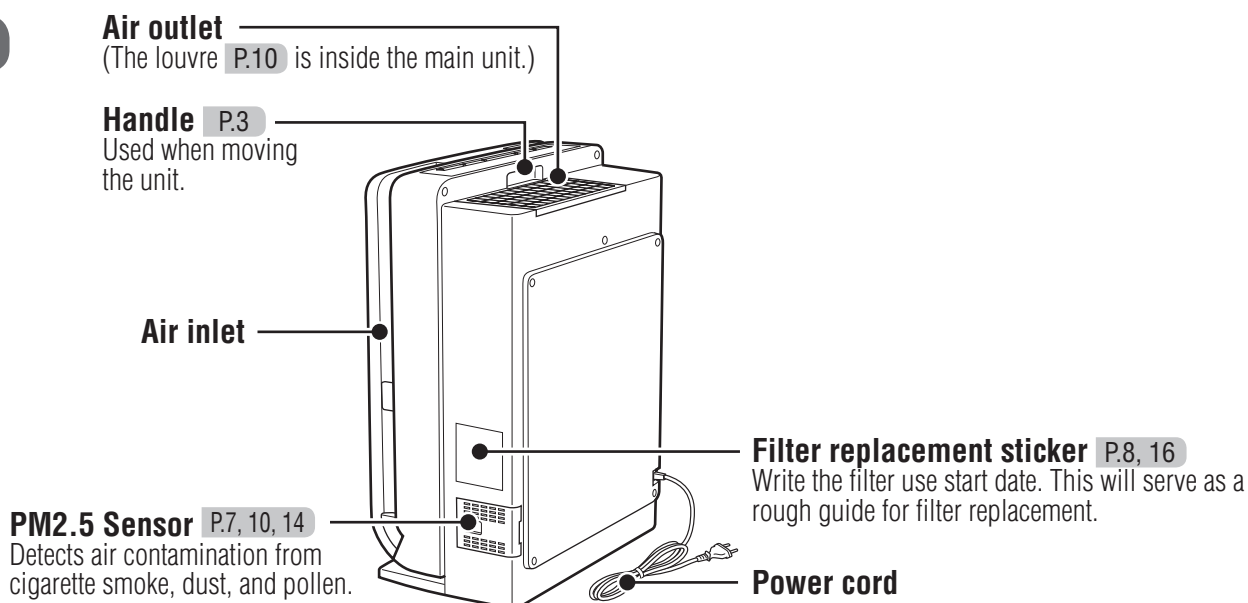

Control Panel

Operation P.9

- **Manual switch**
Changes the air volume.
- **Air volume lamps (green)**
Indicate the air volume during operation.

Operation P.9

- **Auto switch**
Changes the operation.
- **Operation mode lamps (green)**
Indicate the operation mode.

Automatic Cleaning P.11

- **Auto Cleaning switch**
Turns ON/OFF automatic cleaning.
- **Auto Cleaning lamp (yellow)**
Lights during automatic cleaning.

Operation P.9

- **Operation On/Off switch**
Turns ON/OFF operation.

Operating the Louvre P.10

- **Smart Search switch**
Turns the louvre swing OFF/ON.
- **Smart Search lamp (green)**
Lights when Smart Search is ON.

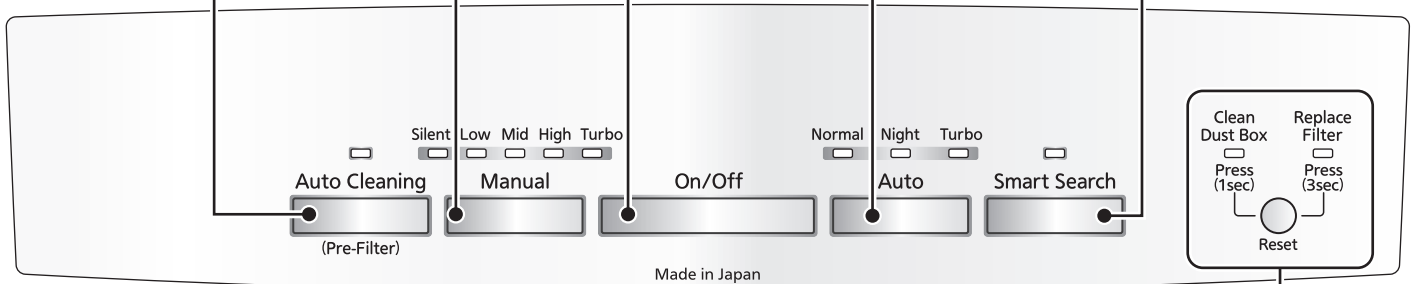

<input type="checkbox"/>	<input type="checkbox"/>	<input type="checkbox"/>
<input type="checkbox"/>	<input type="checkbox"/>	<input type="checkbox"/>
<input type="checkbox"/>	<input type="checkbox"/>	<input type="checkbox"/>
Odor	PM2.5	Dust

● **Triple clean monitors (green/yellow/orange)**
The state of air contamination detected with the odor sensor and PM2.5 Sensor is indicated by lamps lighting in three steps.

<input type="checkbox"/>	<input type="checkbox"/>	<input type="checkbox"/>
<input type="checkbox"/>	<input type="checkbox"/>	<input type="checkbox"/>
<input type="checkbox"/>	<input type="checkbox"/>	<input type="checkbox"/>
Green	Yellow	Orange
Green	Green	Yellow
Green	Green	Green

Air is clean ← → Air is contaminated

- **Clean Dust Box lamp (red)**
When it becomes time to empty the dust box, this lamp lights to notify you. P.14
- **Replace Filter lamp (red)**
When it becomes time to replace the HEPA filter, this lamp lights to notify you. P.16
- **Reset button**
 - Cancels the Clean Dust Box lamp. P.14
 - Cancels the Replace Filter lamp. P.16

Odor monitor
The state of air contamination from cigarette odor and other odors is detected by the odor sensor and then indicated.

Odor sensor
This semiconducting sensor detects odors and other gases. It also responds to wind from air conditioners, electric fans, and other appliances, odorless gases, and perfumes.

PM2.5 monitor
The state of contamination from PM2.5 and other small particles is detected by the PM2.5 Sensor and then indicated.

PM2.5 Sensor
This optical sensor detects the number of particles. The monitor indications are divided into "PM2.5" and "Dust" according to the size of the particles.

* This unit does not detect particles smaller than 0.5 μm.

Adjusting the Sensitivity of the PM2.5 Sensor P.10

Dust monitor
The state of air contamination from pollen, dead bodies of mites, and other large particles is detected by the PM2.5 Sensor and then indicated.

<Size of dirt particles>

Before Use

Preparation

Take the activated charcoal filter out of its plastic bag and then install it.

1 Remove the inlet panel.

Pull the inlet panel toward you while pressing the levers at the bottom.

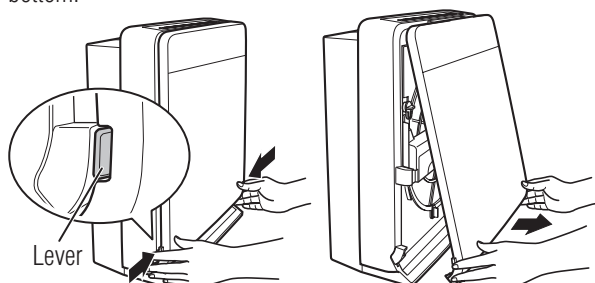

2 Remove the filters.

① Pre-filter unit

Turn the knobs on the left and right and then remove the pre-filter unit.

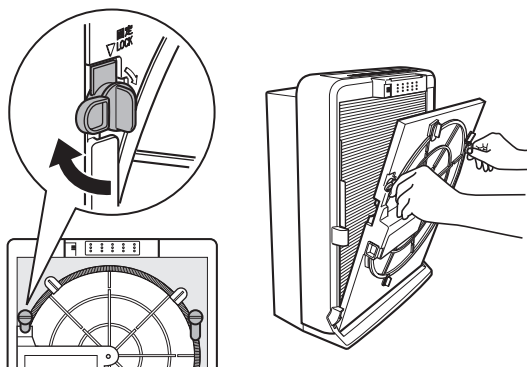

② HEPA filter

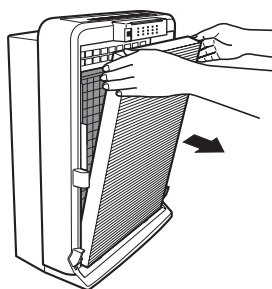

3 Remove the activated charcoal filter and then take it out of its plastic bag.

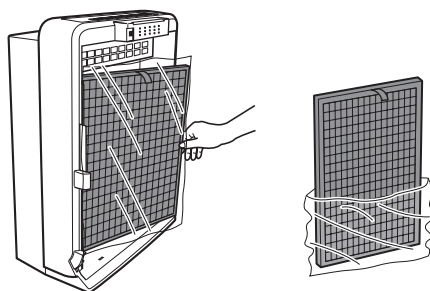

The distribution of charcoal may be uneven and there may be black charcoal powder in the plastic bag, but this will not affect the performance.

4 Attach the filters to the main unit.

① Activated charcoal filter

Push the filter all the way in (there is no front and back).

② HEPA filter

Confirm the installation orientation and then push the filter all the way in.

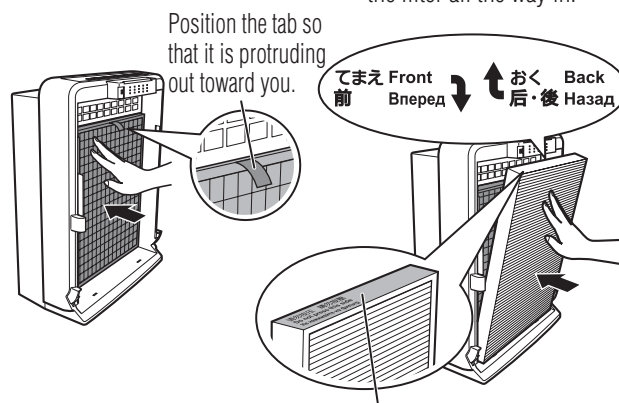

Position the tab so that it is protruding out toward you.

Do not push this surface downward. This may cause deformation.

③ Pre-filter unit

Insert the tabs at the bottom in the two holes in the main unit and then set the knobs on the left and right to the lock position.

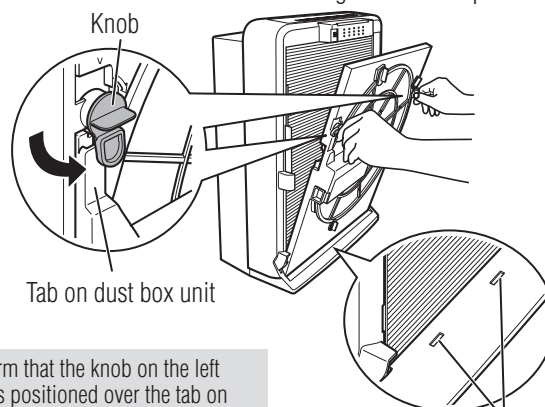

Knob

Tab on dust box unit

Confirm that the knob on the left side is positioned over the tab on the dust box unit.

Holes in main unit (2 places)

5 Attach the inlet panel to the main unit.

Align the inlet panel with both edges of the main unit and then hook the two tabs at the top of the inlet panel onto the main unit and firmly push in the bottom.

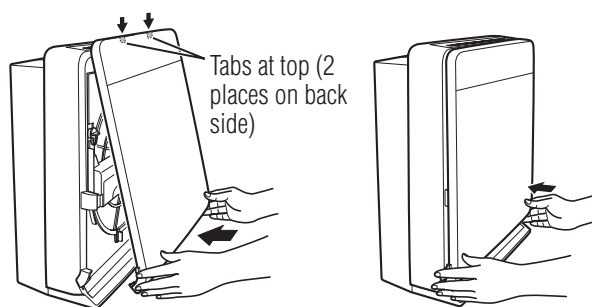

Tabs at top (2 places on back side)

Write the filter use start date on the filter replacement sticker on the right side of the main unit.

Operation

Select from Manual operation (five air volume levels), Auto operation (Normal, Night and Turbo).

Insert the power plug into the power outlet.

Insert the power plug, wait for the “blip” sound, and then press the operation On/Off switch.
(If operation does not start after pressing the operation On/Off switch, press it again.)

1 Start operation.

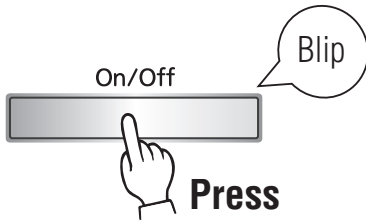

- The operation starts or stops each time you press the switch.
- An operation mode lamp lights up.
- The triple clean monitor lamps light up.

Response will be slow for a few minutes after the operation On/Off switch is turned ON because the PM2.5 Sensor and odor sensor are performing the preparation operation.

2 Change the operation.

■ For operation with a constant air volume (Manual)

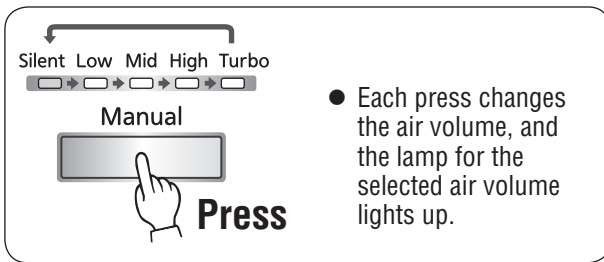

- Each press changes the air volume, and the lamp for the selected air volume lights up.

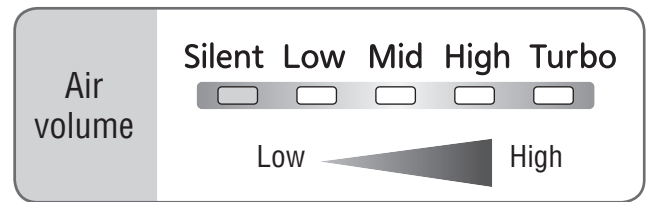

■ For automatic operation depending on the contamination in the air (Auto)

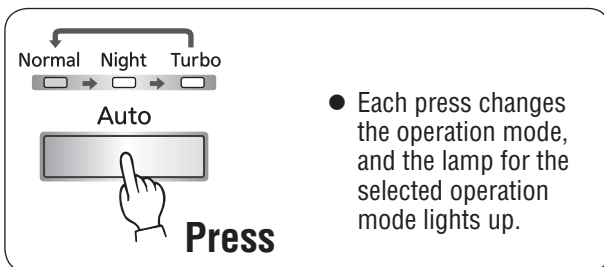

- Each press changes the operation mode, and the lamp for the selected operation mode lights up.

Normal	This is the standard automatic operation. The air volume is changed automatically.
Night	Operation is performed automatically while keeping the air volume low. (The brightness of the lamps on the control panel and the monitor lamps are dimmed slightly.)
Turbo	Operation is performed automatically with the maximum air volume.

To end operation

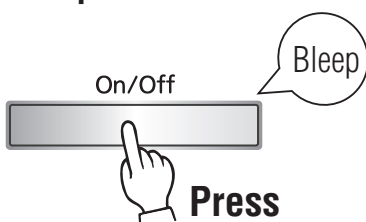

- The operation mode lamp goes out.
- The triple clean monitor lamps go out.

The operation mode is remembered even if the operation On/Off switch is turned OFF or the power plug is disconnected.

Operating the Louvre

When Smart Search is turned ON, the louvre moves in 5 stages and automatically searches for contamination in the air. It can be used in any operation mode.

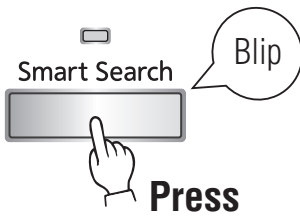

- The Smart Search lamp lights up.
- The operation switches between OFF and ON each time you press the switch.

When the operation On/Off switch is turned OFF, the louvre closes automatically to prevent dust from entering the main unit.

Smart Search

First, the louvre stops at the position shown in ③ below for 30 seconds to create an air flow in the room and search for contamination in the air.

■ If there is no contamination in the air

- The triple clean monitor lamps all light up in green.
- The louvre moves from positions ① to ⑤ below, stopping at each position for 30 seconds, and searches for contamination in the air. (The position it stops at differs depending on the air volume.)

■ If there is contamination in the air

- One of the triple clean monitor lamps will light up in yellow or orange.
- The louvre stops at a position where the air is contaminated and operates. When the air is clean, it moves to the next position.
- The louvre moves to the next position within 15 minutes at most.

<Positions of the louvre>

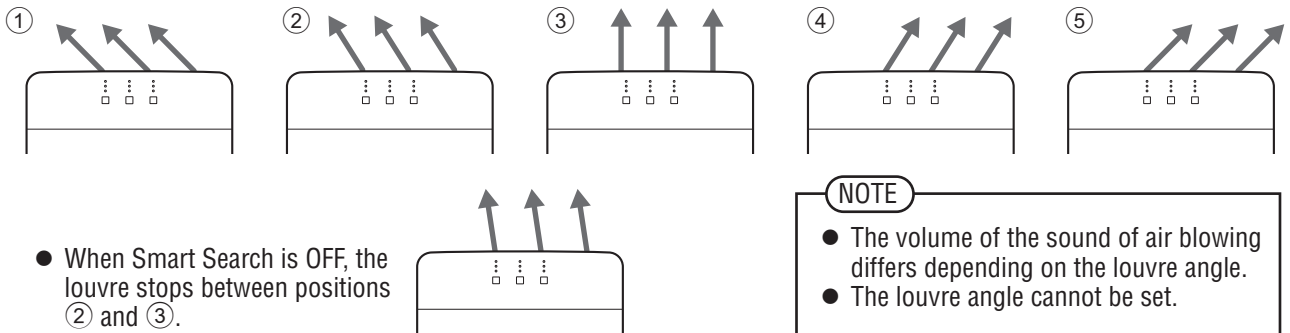

NOTE

- The volume of the sound of air blowing differs depending on the louvre angle.
- The louvre angle cannot be set.

Adjusting the Sensitivity of the PM2.5 Sensor

The sensitivity of the PM2.5 Sensor can be adjusted.

If the air in the room is clean but the triple clean monitor still reacts, make an adjustment.

When operation is OFF



**Press 3 times
within 2 seconds**

- **When the PM2.5 Sensor switches to standard sensitivity**
The unit makes a "blip" sound and the Smart Search lamp flashes.
- **When the PM2.5 Sensor switches to high sensitivity**
The unit makes a "blip blip" sound and the Smart Search lamp lights up.

* The default sensitivity setting is high sensitivity.

Automatic Cleaning (Pre-filter)

A cleaning mechanism inside the main unit cleans the pre-filter automatically.

The pre-filter is cleaned automatically in the following cases.

Automatic cleaning is not performed while the Clean Dust Box lamp is lit. Empty the dust box and then reset it. P.14

- When the Auto Cleaning switch is pressed while the operation On/Off switch is ON
→Cleaning is performed for approximately 2 minute 40 seconds (two rotations of the pre-filter)



- When the total operation time exceeds a certain time while the operation On/Off switch is ON
Approximately 24 hours for "Turbo" manual operation and approximately 120 hours for "Silent" manual operation
→Cleaning is performed for approximately 2 minute 40 seconds (two rotations of the pre-filter)

- The Auto Cleaning lamp lights up.
- The air volume switches to "Low" and automatic cleaning starts.



- When automatic cleaning ends, operation resumes in the previous operation mode.
- The Auto Cleaning lamp goes out.

To stop automatic cleaning part way through the process, press the Auto Cleaning switch. Alternatively, press the Auto switch or Manual switch.

- **Dust is collected into the dust box.**
If the Clean Dust Box lamp lights up, empty the dust box. P.14
 - The Clean Dust Box lamp only serves as a rough guide.
The amount of dust that collects into the dust box will differ depending on the operating environment.
When the air purifier is used in a place with a lot of dust and other dirt, check the dust box and empty it often.
- **Cigarette tar and minute dust particles adhered to the pre-filter will not be removed.**
If such dirt bothers you, wash the pre-filter in water. P.12-13
- **When the cleaning brush becomes dirty, removal of dirt from the pre-filter will become difficult.**
Clean the cleaning brush if it is dirty. P.13

How the Cleaning Mechanism Works

The pre-filter rotates and passes through the dust box

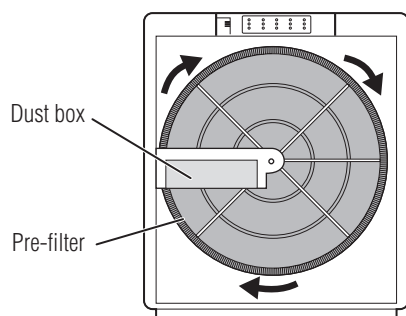

The dirt on the pre-filter is collected with the cleaning brush and accumulates on the scraper plate.

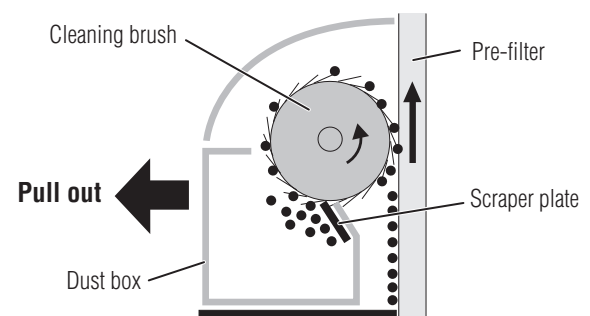

The dust accumulated on the scraper plate may gather together into a long belt-like shape that does not drop into the dust box. If the dust on the pre-filter is removed, the cleaning mechanism is working properly.

Cleaning

To maintain the performance, perform cleaning regularly.

When you clean the unit and filters, always wear a mask and gloves, and wash your hands thoroughly after cleaning.

Timing and Parts to Clean

When dirty

- Main unit P.12
- HEPA filter, pre-filter, and dust box unit P.12-13

When the Clean Dust Box lamp lights up

- Dust box P.14

Approximately once every four months

Approximately once a month

- Sensors (odor sensor and PM2.5 Sensor) P.14

Approximately once every six months

- Lens of PM2.5 Sensor P.14

When there is an odor coming out of the air outlet

- Platinum catalyst and activated charcoal filter P.15

Turn OFF the operation, disconnect the power plug, and check that the blower fan is stopped before cleaning.

Do not use detergent, scouring powder, chemically-treated cleaning cloth, gasoline, benzene, thinner, etc. This may damage the main unit.



WARNING

Remove the power plug before cleaning.
Failure to do so may cause electric shock or injury.

When Dirty

Main unit

Wipe with a soft cloth.

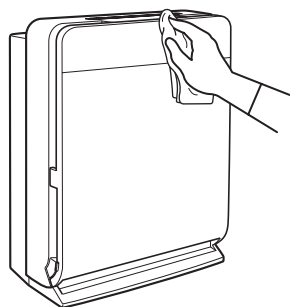

When the unit is very dirty, wipe it with a damp cloth.

When Dirty

HEPA filter, pre-filter, and

1 Remove the inlet panel, empty the dust box P.14, and remove the pre-filter unit P.8.

2 Clean the HEPA filter.

Suck up the dust with a vacuum cleaner using a nozzle with a brush.

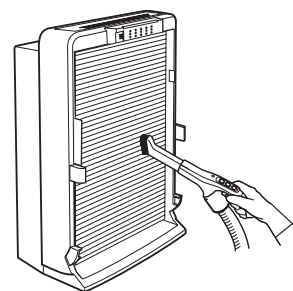

3 Remove the dust box unit and pre-filter.

① Turn the screw and then remove the dust box unit.

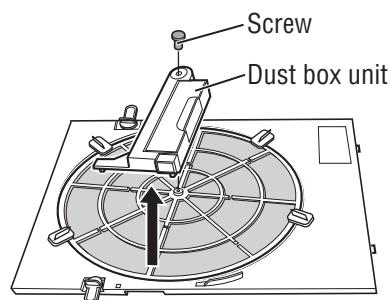

② Turn the knobs (4 places) and remove the pre-filter.

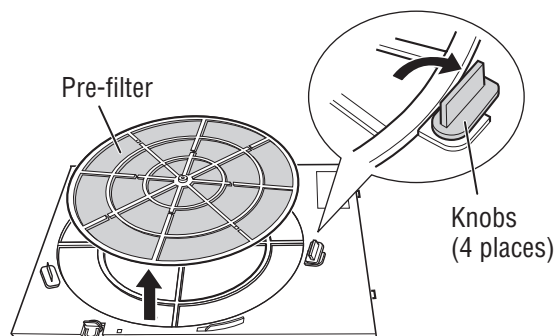

dust box unit

4 Wash the pre-filter in water and then allow it to dry sufficiently in the shade.

Wash with a soft sponge or the like.

Do not use a brush or the like.
This may damage the pre-filter.



5 Clean the cleaning brush.

Suck up the dust with a vacuum cleaner using a nozzle with a brush (if the dust is difficult to remove, remove it with adhesive tape or the like).

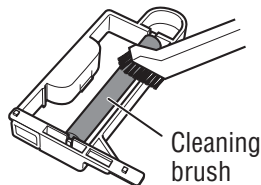

When the cleaning brush is very dirty, wash it in water, and then allow it to dry sufficiently.

Do not remove the cleaning brush.

6 Remove any dirt adhered to the dust box and then attach the dust box to the dust box unit.

When the dust box is very dirty, wash it in water, and then allow it to dry sufficiently.

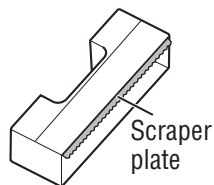

Be careful not to injure yourself with the scraper plate.

7 Attach the pre-filter and dust box unit.

- 1 Attach the pre-filter.

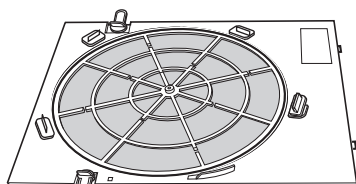

- 2 Turn the knobs (4 places) to the lock position.

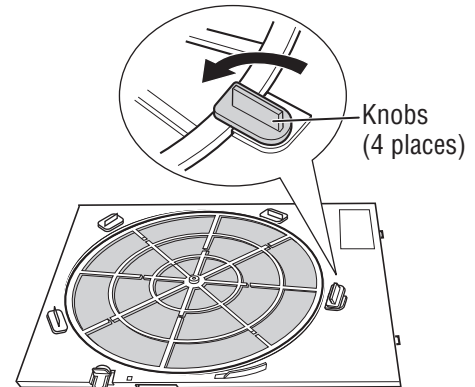

- 3 Insert the tab (1 place) on the dust box unit into the hole in pre-filter unit and then slide the dust box unit.

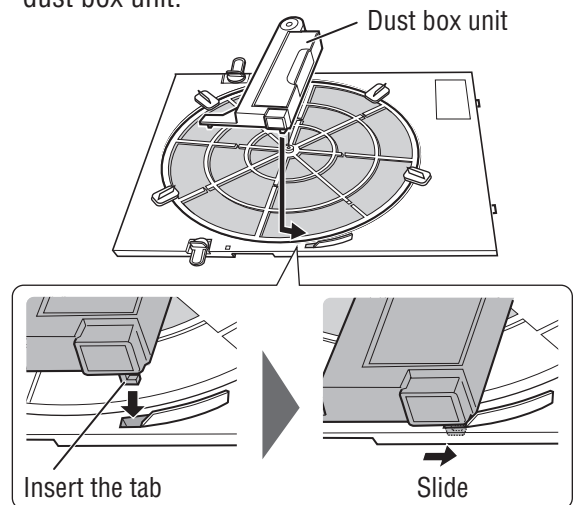

- 4 Tighten the screw.

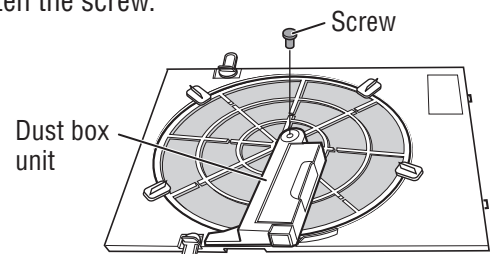

If the dust box unit is not attached properly, the inlet panel cannot be attached. Also, an abnormal (clattering) sound may be heard.

8 Attach the pre-filter unit and inlet panel to the main unit. P.8

Cleaning (Cont.)

When you clean the unit and filters, always wear a mask and gloves, and wash your hands thoroughly after cleaning.

When the Clean Dust Box Lamp Lights Up or Approximately Once Every Four Months

Dust box

- 1 Remove the inlet panel. P.8
- 2 Pull out the dust box and then empty it.

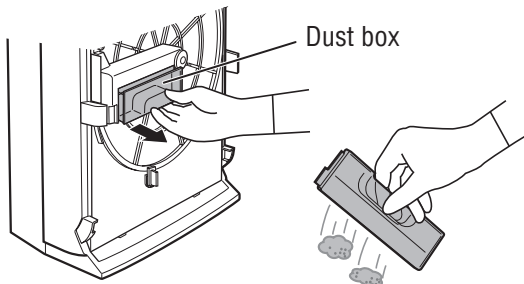

- 3 Attach the dust box.

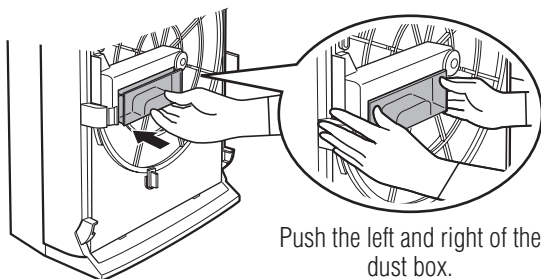

Push the left and right of the dust box.

If it is not attached properly, the removal of dust will become difficult.

- 4 Attach the inlet panel to the main unit. P.8
- 5 Insert the power plug and then reset the Clean Dust Box lamp.

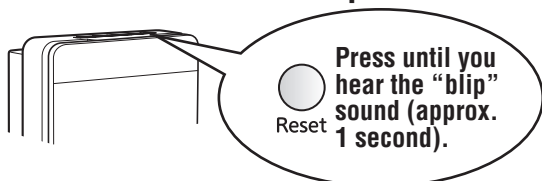

- The Clean Dust Box lamp goes out. (The lamp is reset.)

NOTE

When you hear the “blip” sound, remove your finger from the Reset button. If you keep the button pressed, you will hear a “blip blip” sound and the filter replacement timing will also be reset. P.16

Approximately Once a Month

Sensors

(Odor sensor and PM2.5 Sensor)

- 1 Remove the inlet panel. P.8
- 2 Suck up the dust with a vacuum cleaner using a nozzle.

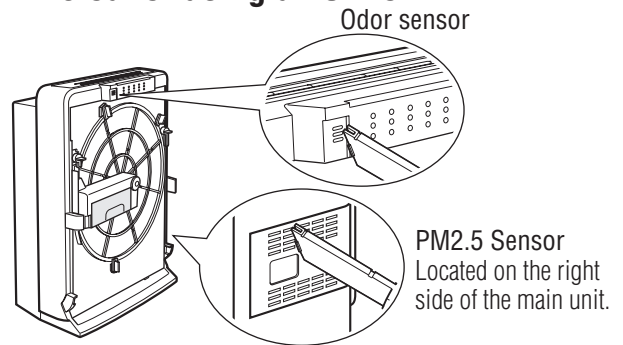

- 3 Attach the inlet panel to the main unit. P.8

Approximately Once Every Six Months

Lens of PM2.5 Sensor

- 1 Remove the cover of the PM2.5 Sensor.
- 2 Clean the lens with a dry cotton swab.

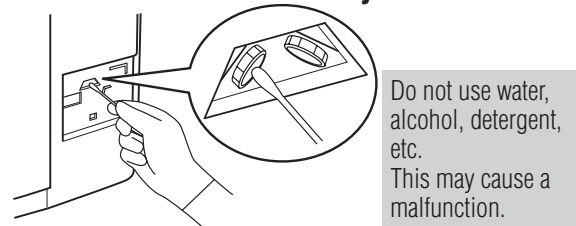

Do not use water, alcohol, detergent, etc. This may cause a malfunction.

- 3 Attach the cover of the PM2.5 Sensor.

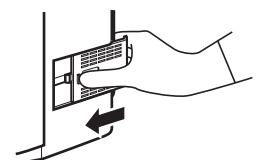

When There is an Odor Coming Out of the Air Outlet

Platinum catalyst and activated charcoal filter

1 Remove the inlet panel, pre-filter unit, and HEPA filter. P.8

2 Remove the activate charcoal filter. P.8

3 Remove the platinum catalyst.

Hook your fingers around the handles at the bottom of the platinum catalyst and then pull the catalyst out toward you to remove it.



4 Soak and wash the platinum catalyst and activated charcoal filter.

● **Platinum catalyst**

Soak in cold or lukewarm water for approximately one hour and then wash in water.

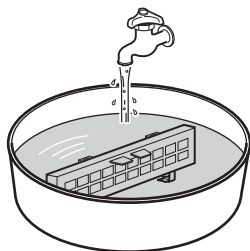

● **Activated charcoal filter**

Soak in cold or lukewarm water for approximately one hour and then wash in water.

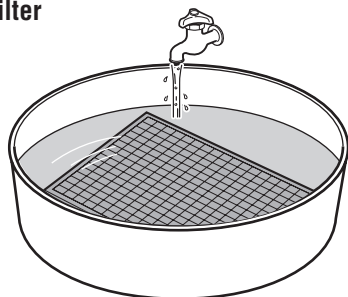

Do not use detergent. Also, do not scrub it. This may cause the platinum catalyst and activated charcoal filter to become damaged.

5 Allow the platinum catalyst and activated charcoal filter to dry.

Allow them to dry properly in a well-ventilated place in the shade for approximately six hours (the drying time differs depending on the season and climate).

- Do not use them while they are still wet. Water drops may be blown from the air outlet and an odor may be created.
- Soaking and washing will not completely restore the deodorizing performance of the activated charcoal filter. Replace this filter when the time for replacement is reached.

6 Attach the platinum catalyst to the main unit.

Hook the top of the platinum catalyst and then push in the bottom.

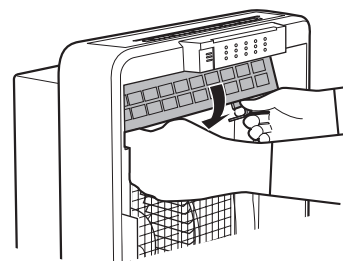

7 Attach the activated charcoal filter to the main unit. P.8

8 Attach the HEPA filter, pre-filter unit, and inlet panel to the main unit. P.8

Replacement of Filters and Disposal

Replace the filters with new ones when the time for replacement is reached.

Replacing the HEPA filter and activated charcoal filter

Rough guide on replacement timing

- When the Replace Filter lamp lights up
The lamp lights up after approximately 8 years with "Silent" manual operation and approximately 1.6 years with "Turbo" manual operation.
- When the HEPA filter becomes very dirty and omits bad odors
- When odors cannot be removed from the activated charcoal filter after soaking and washing it

Turn OFF the operation On/Off switch, disconnect the power plug, and check that the blower fan is stopped before replacing filters.

- 1 Empty the dust box.** P.14
- 2 Remove the HEPA filter and activated charcoal filter and then install new ones.** P.8
- 3 Insert the power plug and then reset the Replace Filter lamp.**

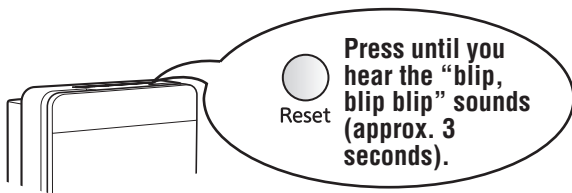

- The Replace Filter lamp goes out.
(The lamp is reset.)

- **The life of the HEPA filter and activated charcoal filter differs depending on operating environment and conditions of use.**
- When replacing the HEPA filter, also replace the activated charcoal filter at the same time.
- The HEPA filter cannot be reused even if it is washed. When it becomes dirty, be sure to replace it with a new one.
- In the following cases, odors may adhere to the HEPA filter and main unit. Clean the main unit and replace the HEPA filter.
 - When a lot of cigarettes are smoked
 - When there are a lot of odors in the room

Disposal

Dispose of the filters and main unit in accordance with the local regulations on disposal.

- **HEPA filter**
Materials: PP (polypropylene), rayon, and PET (polyethylene terephthalate)
- **Activated charcoal filter**
Materials: Activated charcoal, PET (polyethylene terephthalate), and PS (polystyrene)
- **Main unit**
Dispose of the main unit in accordance with the local regulations on disposal without disassembling it.

Consumable parts

- **Replacement filter set**
 - Two-layer HEPA filter
 - Special washable activated charcoal filter
 - Model MAPR-866HFT
 - Model code 5D4 827

Purchase from the retail store where you purchased the product.

Troubleshooting

Before requesting repairs, thoroughly read this Instruction Manual, and check the following points.

Symptom	Cause and Remedy
The air purifier does not operate.	<ul style="list-style-type: none"> ● Has the power plug become disconnected? → Firmly insert the power plug into the power outlet. P.9 ● Is an air volume lamp or operation mode lamp lit? (Is the operation On/Off switch ON?) → Turn ON the operation On/Off switch. P.9
The bottom of the inlet panel cannot be attached.	<ul style="list-style-type: none"> ● Is the tab (1 place) on the dust box unit inserted in the hole properly? → Attach the dust box unit properly. P.13
The main unit vibrates a lot.	<ul style="list-style-type: none"> ● Did you install the main unit on a surface that is not flat or stable? → Install the main unit on a table or other surface that is flat and stable. P.3
Odor and smoke are difficult to remove.	<ul style="list-style-type: none"> ● Is the pre-filter dirty? → Clean the pre-filter. P.12-13 ● Are the filters dirty? → Replace the filters. P.16 ● Is there dust on the PM2.5 Sensor and odor sensor? → Clean the PM2.5 Sensor and odor sensor. P.14
The operation noise and vibration have increased.	<ul style="list-style-type: none"> ● Are you operating the air purifier with “Turbo” or “High” manual operation or “Turbo” automatic operation? → The sound is louder for operation with a high air volume. If the sound bothers you, select an operation mode with a low air volume. P.9 ● Is the pre-filter dirty? → Clean the pre-filter. P.12-13 ● Are the filters dirty? → Replace the filters. P.16 ● Is the activated charcoal filter installed in the main unit still inside the plastic bag? → Take it out of its plastic bag and then attach it again. P.8
<div style="display: flex; align-items: center;"> <div style="writing-mode: vertical-rl; transform: rotate(180deg); font-weight: bold; padding-right: 5px;">During automatic cleaning</div> <div style="flex-grow: 1;"> <p data-bbox="150 1503 501 1543">A clattering sound is heard.</p> <p data-bbox="150 1621 413 1693">A buzzing sound has become loud.</p> </div> </div>	<ul style="list-style-type: none"> ● Is the dust box unit attached to the pre-filter unit properly? → Attach the dust box unit properly. P.13 ● A buzzing sound is emitted during the cleaning of the pre-filter because the motor is running. If a lot of dust adheres to the cleaning brush, the buzzing noise may become loud. → When the noise bothers you, perform cleaning. P.12-13
The main unit makes a sound when being moved.	<ul style="list-style-type: none"> ● Are you moving the air purifier while it is operating? → If the main unit is suddenly moved or tilted, sound may be emitted. P.3

Troubleshooting (Cont.)

Symptom	Cause and Remedy
When looked through the air outlet during operation, the blower fan is vibrating.	<ul style="list-style-type: none"> ● This is not a problem as long as there is no abnormal noise or abnormal vibration.
When the power plug is disconnected, sometimes a bleep or buzzing sound can be heard.	<ul style="list-style-type: none"> ● Did you disconnect the power plug while the operation On/Off switch is ON? → Turn OFF the operation On/Off switch before disconnecting the power plug.
Triple clean monitors The monitor indications are slow to change. The monitors respond very infrequently. The monitor indication does not change despite the existence of an odor. The monitor responds even though the air in the room is clean.	<ul style="list-style-type: none"> ● If the room is large, the air may take a while to become clean. ● If there is a lot of dust and odor, the air may take a while to become clean. <p><How to check monitor operation></p> <ul style="list-style-type: none"> ● Rub tissue paper near the PM2.5 Sensor so as to create dust. ● Place perfume, hair tonic, or the like on tissue paper and then place the tissue paper in front of the main unit so that the fragrance is sucked into it.
	<ul style="list-style-type: none"> ● Is there dust on the PM2.5 Sensor and odor sensor? → Clean the PM2.5 Sensor and odor sensor. P.14 ● Response will be slow for a few minutes after the operation On/Off switch is turned ON because the PM2.5 Sensor and odor sensor are performing the preparation operation.
	<ul style="list-style-type: none"> ● The monitor indication may not change sometimes because the sensitivity of the sensor differs depending on the components of the odor.
	<ul style="list-style-type: none"> ● The monitor may sometimes respond to the wind from an air conditioner in the room or gas that is difficult for a human nose to sense. P.7 ● Is there dust floating in the air? If there is even a small amount of dust floating in the air, the monitor may respond. ● Adjust the sensitivity of the PM2.5 Sensor and wait and see. P.10
The Replace Filter lamp is lit.	<ul style="list-style-type: none"> ● It is time to replace the HEPA filter and activated charcoal filter. → Replace the HEPA filter and activated charcoal filter. P.16
The Clean Dust Box lamp is lit.	<ul style="list-style-type: none"> ● It is time to clean the dust box. → Clean the dust box. P.14
The dust on the pre-filter cannot be removed. (The pre-filter does not rotate.)	<ul style="list-style-type: none"> ● Is the dust box attached properly? → Attach the dust box properly. P.14 ● Are the pre-filter unit and dust box unit securely attached? → Attach the pre-filter unit and dust box unit properly. P.8 P.12-13
The pre-filter is dirty.	<ul style="list-style-type: none"> ● The cleaning mechanism is a function for removing dust on the pre-filter. Cigarette tar and minute dust particles will not be removed. → If such dirt bothers you, wash the pre-filter in water. P.12-13

If the symptoms persist even after trying the remedies above, stop using the air purifier and disconnect the power plug, and then contact the retail store where you purchased the product.

Specifications

Model	MA-E85R-A				
Power supply	230-240 V AC, 50 Hz				
Manual operation	Turbo	High	Middle	Low	Silent
Power consumption	86 W	23 W	11 W	8 W	6 W
Air volume	510 m ³ /h	306 m ³ /h	204 m ³ /h	150 m ³ /h	102 m ³ /h
Weight	9.9 kg				
Dimensions	547 (H) × 425 (W) × 244 (D) mm				
Cord length	1.8 m				

SOLE AGENT in Australia

MITSUBISHI ELECTRIC AUSTRALIA PTY LTD.

(Incorporated in New South Wales) ABN 58 001 215 792
348 Victoria Road, Rydalmere NSW 2116

For more information and support contact

Website: www.mitsubishielectric.com.au

Call 1300 651 808

SOLE AGENT in New Zealand

BLACK DIAMOND TECHNOLOGIES LIMITED (BDT)

Website: <https://www.mitsubishi-electric.co.nz>

Wellington Office (Head Office)

1 Parliament Street, Lower Hutt, PO Box 30772, Lower Hutt 5040 Phone: (04) 560 9147, Fax: (04) 560 9133

Auckland Office

Unit 1, 4 Walls Road, Penrose, PO Box 12726, Penrose, Auckland 1642 Phone: (09) 526 9347, Fax: (09) 526 9348

Christchurch Office

44 Halwyn Drive, Hornby, PO Box 16904, Hornby, Christchurch 8441 Phone: (03) 341 2837, Fax: (03) 341 2838

For after sales and service

Phone: 0800 737 842, Fax: 0800 845 632

Fill in the following for your future reference.

Place of purchase:	Telephone number:		
Authorised service centre:	Telephone number:		
Date of purchase:	Day	Month	Year

MITSUBISHI ELECTRIC CORPORATION

Website: <https://www.mitsubishielectric.com>