



# Diamond Digital

## DX-D193P

### 19" TFT-LCD Security/AV Display with protective screen



The DX-D193P from Mitsubishi Electric Australia is perfect for use in a wide variety of work environments. From security and surveillance, to classrooms or warehouse, or even public display, this versatile monitor includes a number of quality features designed to suit your needs.

#### Protective Screen

The tempered glass screen protects the TFT-LCD panel from damage by external forces.



#### Four Scanning Types

There are four available scanning options to choose from for added viewing flexibility.

Scan Type



#### DC 12V Power Output

Supplies power for a single camera.



# MITSUBISHI ELECTRIC AUSTRALIA

# 19" Security/AV display with protective screen

## DX-D193P

### Features

- SXGA (1280 x 1024 Pixel) resolution
- Anti-reflective, tempered glass screen shield
- 500 TVL
- 5ms response time (tr+tf)
- Adaptive 3D Comb Filter
- Four scanning modes
- DC 12V Power output - supplies power to a single camera
- Deinterlacing function for smoother, clearer images
- Picture in Picture functionality
- Easy to use on-screen controls
- Multiple computer and video inputs
- Wall or Rack mountable (VESA standard)
- 3 Year limited warranty

### Dimensions and Input Ports

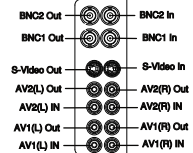
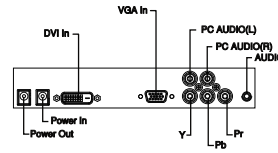
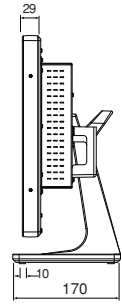
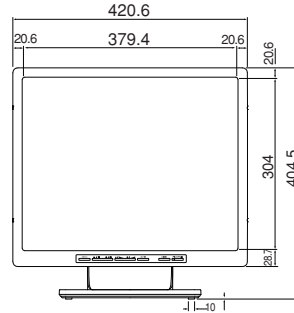

### Optional Mounting Accessories

RAK191 - 19" Rack mounting bracket (8RU)

WB191 - Wall mounting bracket

CM191 - Ceiling mounting bracket

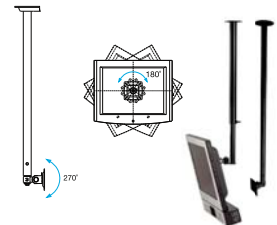
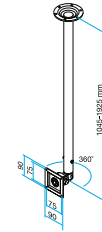
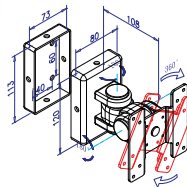
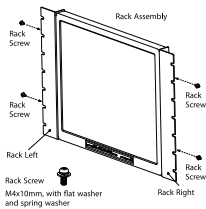
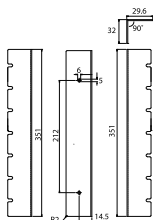

### Specifications\*

Item	Description
LCD display	19.0" Active Matrix TFT LCD Panel
Viewable size	376.32mm (H) × 301.06mm (V)
Pixel pitch	0.294(H) × 0.294 (V)mm
Max. resolution	500TVL / 1280 × 1024 (SXGA)
Contrast ratio	1000:1
Brightness	250 cd/m <sup>2</sup>
Response time	5ms (tr / tf)
Display color	16.7M
Viewing angle	160°(H) / 160°(V)
Panel life	50,000 hrs
Scan freq.	Horizontal: 31.5K~80KHz Vertical: 56~75Hz
Display mode	VGA, DVI, Composite, S-VIDEO, Component
Signal connector	DC In/Out, VGA (15-pin D-sub) In, DVI-D In, 2 x Composite(BNC) In/Out, S-Video In/Out, Component(RCA) In, 2 x Audio(RCA) In/Out, Audio(RCA) In, PC Audio(stereo mini-jack) In
Front control panel buttons	Power on/off, LED indicator, Input Mode, Increase (Volume Increase), Decrease (Volume Decrease), Up(Contrast Adjust), Down (Brightness Adjust), Menu, Auto Adjustment
OSD menu	VGA: Brightness, Contrast, H-Position, V-Position, Clock, Phase, Color Temp., User Color R.G.B, OSD H-Pos., OSD V-Pos., Volume, PIP/POP, Language, Power-saving, Recall. Video: Color, Brightness, Contrast, Sharpness, Volume, H-Position, Language, Color Temp., Scan, PIP, PIP Size/Pos., Recall.
De-interlace	Yes
3D comb filter	Yes
Audio speaker	2W Stereo
Power input/output	DC Input: 12V/4.0A ; DC Output 12V/ 500mA
Power consumption	45W (Max.)
Power failure auto recovery	Yes
Power management	VESA DPMS compatible
Operating condition	Temperature: 0°C~40°C Humidity: 20%~80%
Dimension (WxHxD)	420.6×404.5×170mm
Weight	6.98kgs
Safety	AS/NZS 60950

\*For future improvement, specifications, designs of product and availability are subject to change without notice

**MITSUBISHI ELECTRIC AUSTRALIA**

348 Victoria Rd Rydalmere, NSW 2116 Phone: (02) 9684 7777 Fax: (02) 9684 7208

[www.MitsubishiElectric.com.au](http://www.MitsubishiElectric.com.au)